

The Courses and distances  
up the River are as followeth  
 S 30° E. 130 ps  
 S 15° E. 47 ps  
 S 5° W. 54 ps  
 S 42° W. 37 ps  
 268

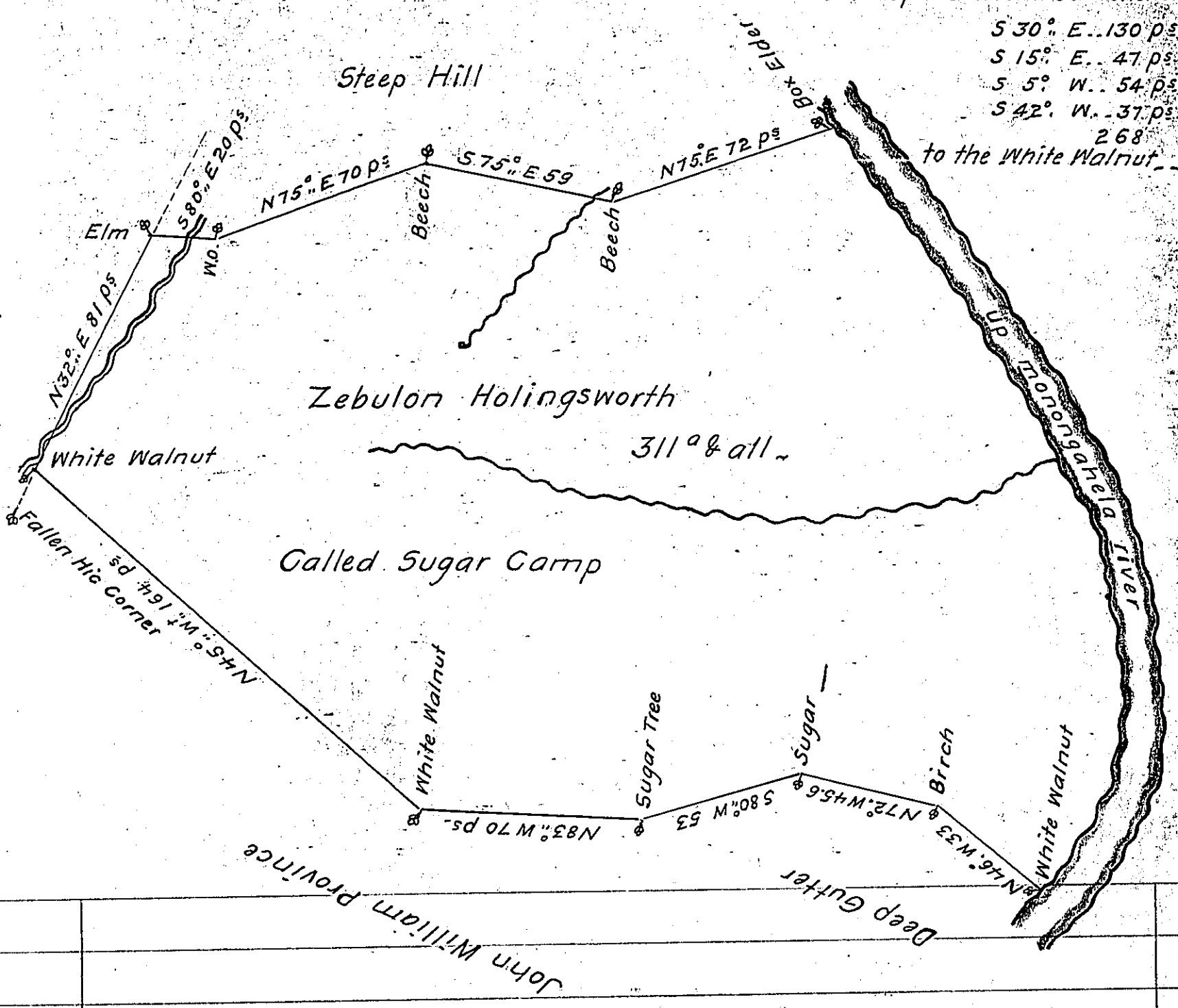

Situate on the West Side of Monongahela River below the  
 Mouth of Laurel Run in the County of Westmoreland and Surveyed the  
 26<sup>th</sup> day of January 1774. In pursuance of a Warrant dated the 3<sup>d</sup>  
 day of July 1773.

A. M. Lane Dep<sup>t</sup>

To John Lukens Esq. S.G.

IN TESTIMONY that the above is a copy of the original remaining on file in  
 the Department of Internal Affairs of Pennsylvania, made  
 conformably to an Act of Assembly approved the 16th day of  
 February, 1833, I have hereunto set my Hand and caused  
 the Seal of said Department to be affixed at Harrisburg,  
 this twenty-fourth day of March 1905

*Isaac D. [Signature]*  
 Secretary of Internal Affairs.